



TILE & STONE FIXING EXPERT



# T16 CERA CLEAN

HIGH PERFORMANCE  
TILE CLEANER



For Internal  
& External  
Floor & Wall



Dilute  
with Water



Easy to use



Protect the color  
& shine of tile



Removes  
difficult stains



Not Harmful



Available in 500 ml,  
1 ltr & 5 ltr pack



# CERA CLEAN

## DESCRIPTION

Roff Cera Clean is a high quality rapid active cleaner and degreasing solution for use on tiles, bathtubs, wash basin, privy basin and concrete etc. It is used to clean whitish spot/layer as normally observed in the bathroom under plastic/ metal buckets (normal detergent is not helpful) with ease.

It is also used as rapid removal of white yellowish spot/layer along with water stains over tiles, cement stains, grime, oil, paint stains, grease, moss and wax from concrete, asbestos, terrazzo and ceramics.

## STANDARD COMPLIANCE/ SPECIFICATION

Roff Cera Clean complies to Class 2 requirements as per "IS 13630 part 8 : 2006 - Method of test, Sampling & basis for acceptance for determination of Stain and Chemical Resistance of glazed tiles"

## AREA OF USE

Surface to be cleaned	Area of application
<p>Stain cleaning for ceramic tile, glazed tiles, porcelain tiles, vitrified tiles, glass mosaic tiles &amp; sanitaryware.</p> <p>Cleaning moss and wax from concrete, asbestos, terrazzo and ceramics. Surface before &amp; after application of epoxy products. Natural stones*</p>	<p>Cleaning floor and wall tiling in kitchen, bathrooms, toilets, garages, factories, general building sites &amp; residential tiling. Internal &amp; external tiling area.</p> <p>Domestic &amp; commercial tiling area. Routing tile cleaning with mop in bathroom &amp; other tiling area.</p>

### Note :

\*Check Roff Cera Clean before using for cleaning of coloured concrete, granite, marble stone flooring with corner test because it may etch the surface. (If stone shows discoloration up to 24 hrs. after application, do not use product).

## FEATURES AND ADVANTAGES

- Easy to use - just mix with water & clean the surface.
- Removes difficult stains easily - Fast & effective.
- Degreases the tile surface easily for soaps, scum, efflorescence, mineral deposit.
- Cleans all types of tile like ceramic, porcelain & vitrified tile and grout.
- Protects the color & shine of tile.
- Does not damage joints between ceramic tiles, even those grouted with colored products.
- Not harmful like acid.

## LIMITATIONS

- Check Roff Cera Clean before using for cleaning of coloured concrete, granite, marble stone flooring & other stones with corner test because it may etch the surface. (If stone shows discoloration up to 24 hrs. after application, do not use product)..



## CERA CLEAN

### TECHNICAL INFORMATION

#### PHYSICAL & APPLICATION PROPERTIES

Testing Properties	Test Results
Density	1.02 ± 0.02 kg/ litre
Color	Reddish Liquid
Viscosity	Equal to water
Soaking Time	5 minutes
Dilution with Water	Dilution with water will depend upon substrate condition & Stain severity.

#### RESISTANCE TO STAINING AS PER IS 13630 PART 8: 2006 (1 : 1 DILUTION WITH WATER)

Testing Properties	Requirement
Pickle	Resistant, Class 2
Turmeric	Resistant, Class 2
Wine	Resistant, Class 2
Oil	Resistant, Class 2

**Note :** Above data was obtained at 25 ±2°C and 50% relative humidity. Data may vary depending on specific conditions at the building site, i.e. temperature, ventilation and absorbency level of the substrate and of the materials laid.

## CERA CLEAN

### APPLICATION INSTRUCTIONS



- For mild blemish spots/ layers, mix Roff Cera Clean with water with 1: 1 proportion.
- Soak the cloth or sponge in the diluted solution and rub the surfaces till the spots/layers are removed.
- For stubborn spots/ layers neat Roff Cera Clean liquid (without mixing with water) shall be used for cleaning. Please check this in small areas before cleaning the complete area.
- For routine tile cleaning, dilute two capful Cera Clean with half bucket water & use diluted solution for cleaning the tiles & sanitaryware.

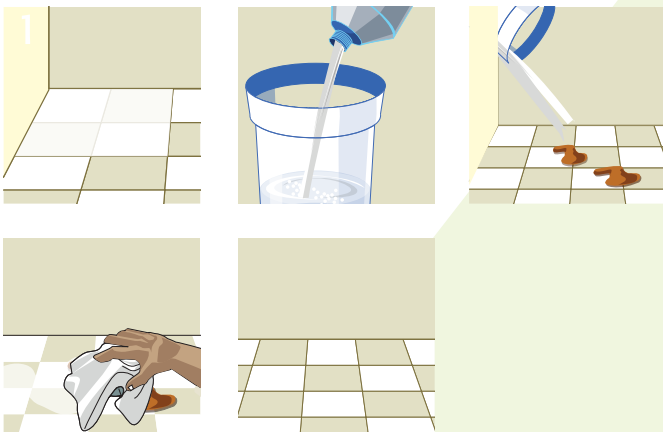

### PRECAUTIONS & NOTE

- It is advisable to use clinical gloves while using Roff Cera Clean as some people with sensitive skin may experience mild itching or irritation.
- Check Roff Cera Clean before using for cleaning of colored concrete, granite, marble stone & other natural stones with corner test because it may etch the surface. (If stone shows discoloration up to 24 hrs. after application, do not use product).
- Consult Roff Technical Services for recommendations for unusual conditions.

### COVERAGE

Coverage would dependent upon porosity & contamination of substrate.

### PACKAGING

500 ml, 1 litre & 5 litre

### SHELF LIFE

12 months for sealed pack when stored under cover, out of direct sunlight, dampproof condition and protect from extremes of temperature

### SAFETY PRECAUTIONS

Keep out of reach of children. Wear suitable protective clothing, gloves and eyes/face protection. After contact with skin, wash immediately with plenty of clean water. In case of contact with eyes rinse immediately with plenty of clean water and seek medical advice. Limited to professional use only.

For more details please refer the relevant Material Safety Data Sheet, available on request.